

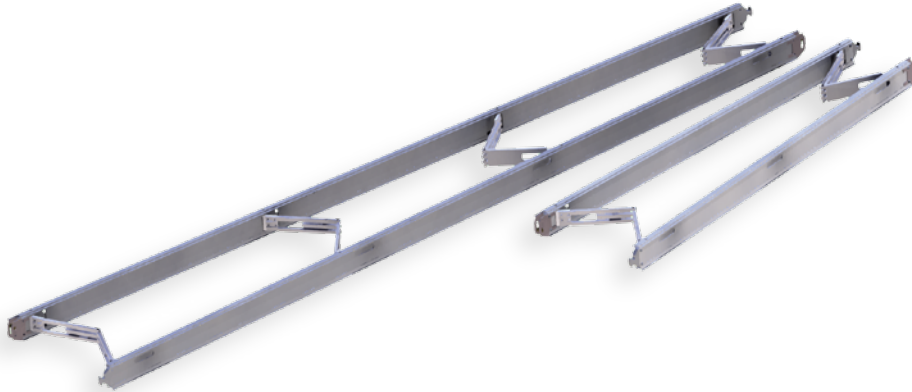

KEY GRIP SYSTEMS
Development

TRACK SYSTEMS

Frames



Produced with our constant concern for quality, KGS Development foldable frames are very useful for laying long dolly tracks over rough terrain. They allow adjustment time to be reduced significantly due to the rigidity of their structure and a unique coupling system. (Patent pending)

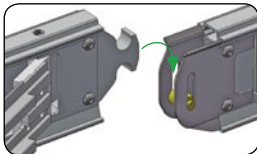

The male/female connectors automatically position the frames precisely in all types of conditions.

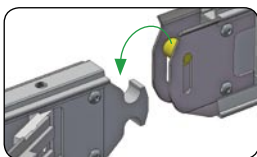

This system of symmetrical connections (Patent pending) allows frames to be joined without taking their direction into account.

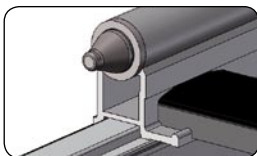

The frame profile is designed to be fixed to our Tracks and Monotracks with maximum safety.



The stackable profiles allow load bearing to be increased, thus reducing space needed for storage and protecting the hinges during handling.

The foldable frames are available with 3 different wheel-bases (620, 880 and 1000 mm) and in 2 different lengths: 4 m and 2 m.



KEY GRIP SYSTEMS
Development

TRACK SYSTEMS

Frames

620 mm width



ref.	length
FFE001	2 m
FFE002	4 m

880 mm width



ref.	length
FFE003	2 m
FFE004	4 m

1000 mm width



ref.	length
FFE005	2 m
FFE006	4 m

All widths and lengths are available upon request.